

# duraflo<sup>®</sup> INSTALLATION GUIDE

## PROVentilator Installation Instructions

### duraflo<sup>®</sup> PROVentilator

#### Installation instructions

For replacing existing vents please see Duraflo.com

**Note:** PROVentilator placement and balancing the amount of intake and exhaust venting are extremely important in achieving ideal ventilator performance. For more information on ventilation systems see Duraflo.com or consult the local building code.

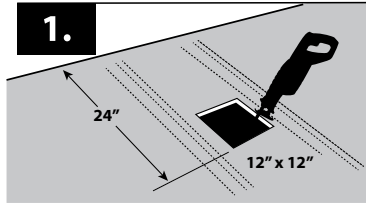

1. Apply underlayment on the sheathing and in the center of the rafters cut a 12" square hole. The edge of the hole should be at least 12" and no more than 24" from the roof peak.

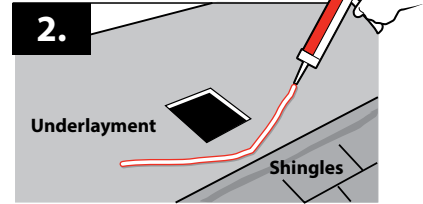

2. Using a 1/2 inch bead, apply a generous amount of construction sealant to the underlayment in front of hole before applying next shingle course.

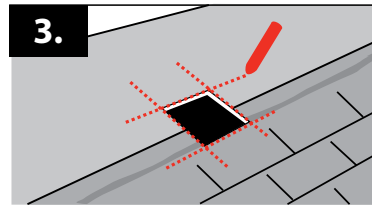

3. Install next shingle course over sealant bead and mark extended chalk lines to help position vent over opening in next step.

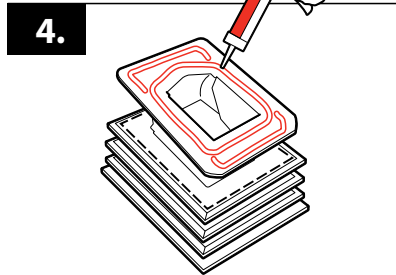

4. Using a 1/2 inch bead, apply a generous amount of construction sealant to the base of the vent.

**Note:** Use non-petroleum based sealants only. The use of petroleum based sealants may void any manufacturer's product warranty.

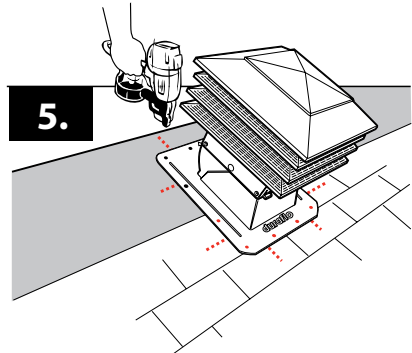

5. Position the roof vent over the cut opening in the roof. Center the vent by aligning edges of the vent throat with the chalk lines previously marked. Using the molded nail indicators, nail the top half of the vent securely into place.

6.

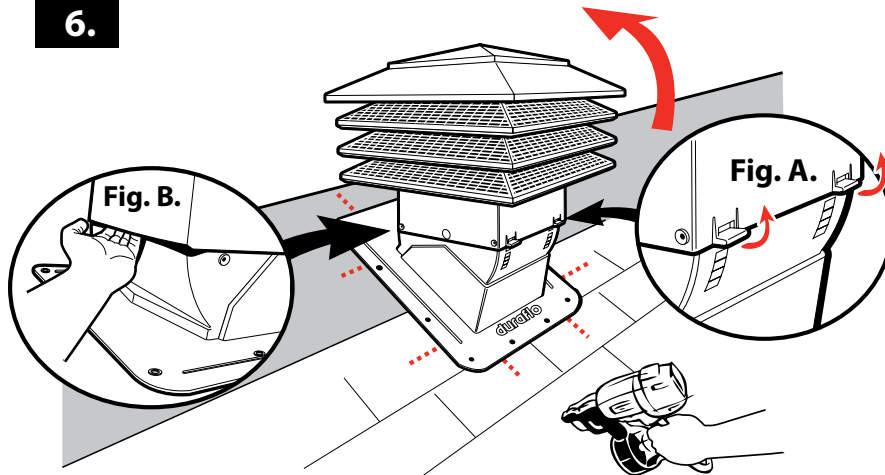

6. Gently lift the pitch calculating tabs (Fig A.), rotating the top of the unit up to make room for nailing the bottom half of the flange (Note: Ensure the vent throat overlaps (Fig B.)). Using the molded nail indicators, nail the remainder of the vent securely into place.

**Note:** For added protection against weather infiltration caulk any exposed nail heads.

7.

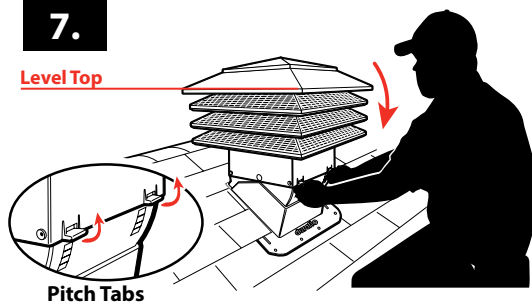

7. Using the pitch tabs lower the top of the unit back to desired pitch. Ensure the top of the unit is level.

8.

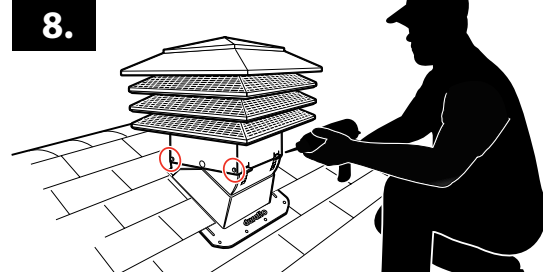

8. Using the 4 screws supplied, secure vent into position as shown.

Canplas Industries Ltd.  
500 Veterans Drive, P.O. Box 1800  
Barrie, Ontario, Canada L4M 4V3  
Tel. (705) 726-3361  
Toll Free 1-800-461-5300  
Fax: (705) 726-2186

[www.duraflo.com](http://www.duraflo.com)

1-800-461-5300 [www.duraflo.com](http://www.duraflo.com) **duraflo<sup>®</sup>**

**canplas<sup>®</sup>**